

# Quick *Reference Guide*



## WARNING

Read and fully understand instruction manual before using this product. Failure to follow operating instructions could result in death or serious injury.

Model: **190655**

## Contents

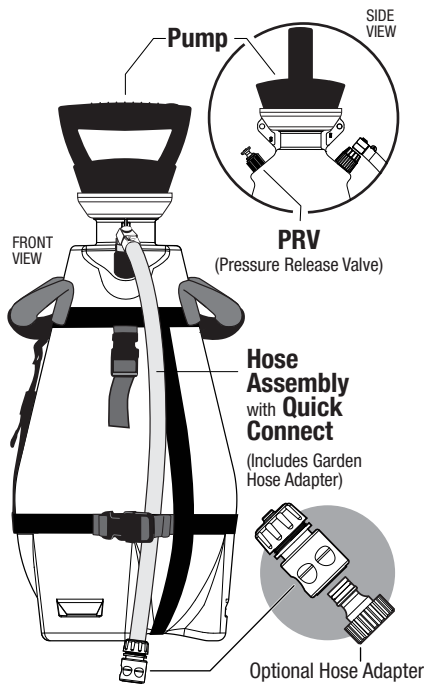

**Fully Assembled Tank with Harness**

## Setup

**1**  
Hose to Tank

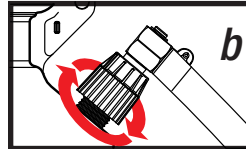
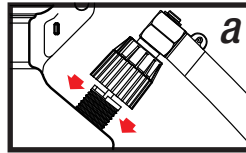

**2**  
Fill with Water

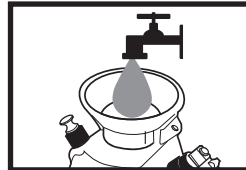

Quick Connect

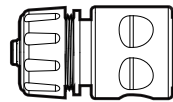
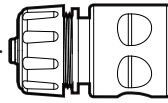

Optional Hose Adapter

## Use

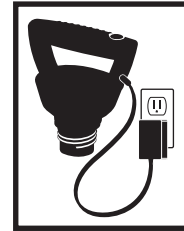

**1. Charge**

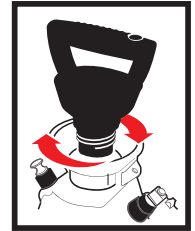

**2. Twist On**

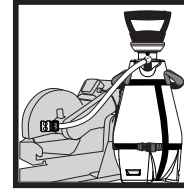

**3. Connect to Saw**

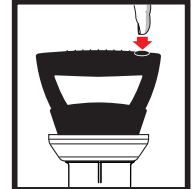

**4. Power On**

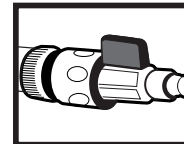

**5. Bleed Air Out of Line Prior to Equipment Use**



**6. Power Off**

## Stabilizing Strap

**1** Align Hose

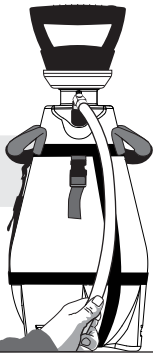

**2** Clip Hose into Gravity Strap



**3** Hose Clipped



## Hose Storage Strap

**1** Coil Hose Around Tank

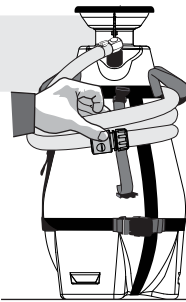

**2** Clip Hose into Storage Strap

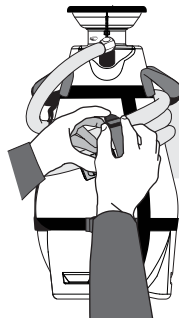

**3** Hose Fully Stored

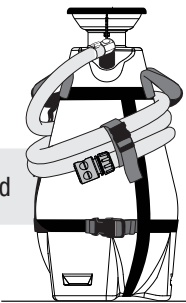

## Cleaning

**1**  
Release Pressure

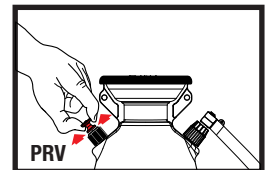

**2**  
Drain Water  
Push and Hold Valve Open

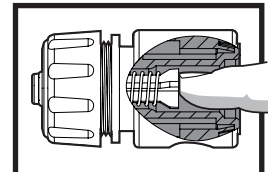

**3**  
Rinse Tank



## Replacement Parts List

Fully Assembled	No. 190655
Quick Connect	No. 183820
Hose Assembly	No. 183821
Pump and Charger Kit	No. 184163
Harness	No. 183819
PRV	No. 182945



**AVERTISSEMENT**

Veuillez lire et comprendre le manuel d'instruction avant d'utiliser ce produit. Le non-respect des directives d'utilisation pourrait causer la mort ou des blessures sérieuses.



**ADVERTENCIA**

Lea y comprenda todo el manual de instrucciones antes de usar este producto. No seguir las instrucciones de operación podría provocar la muerte o lesiones graves.

**Contenu**  
**Contenido**

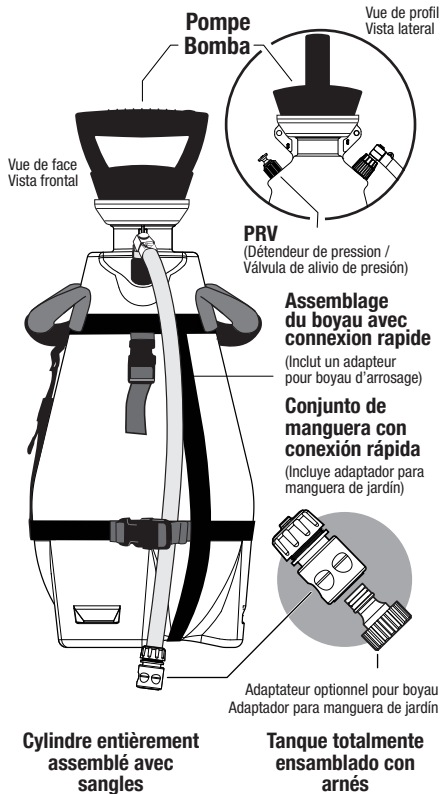

Cylindre entièrement assemblé avec sangles

Tanque totalement ensablado con arnés

**Assemblage**  
**Preparación**

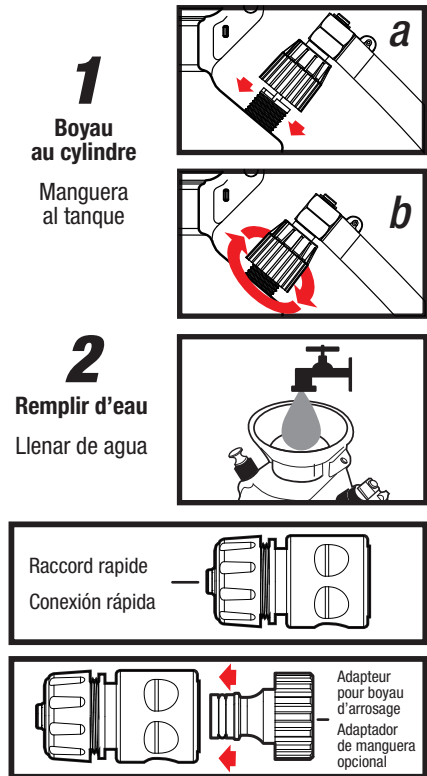

**Utilisation**  
**Usar**



**Courroie de stabilisation**  
**Correa de estabilización**

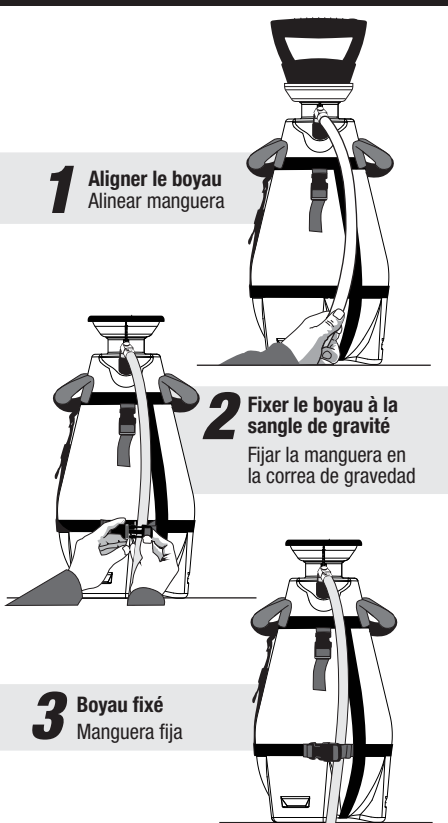

**1** Aligner le boyau  
Alinear manguera

**2** Fixer le boyau à la sangle de gravité  
Fijar la manguera en la correa de gravedad

**3** Boyau fixé  
Manguera fija

**Courroie d'attache pour boyau**  
**Correa de almacenamiento de manguera**

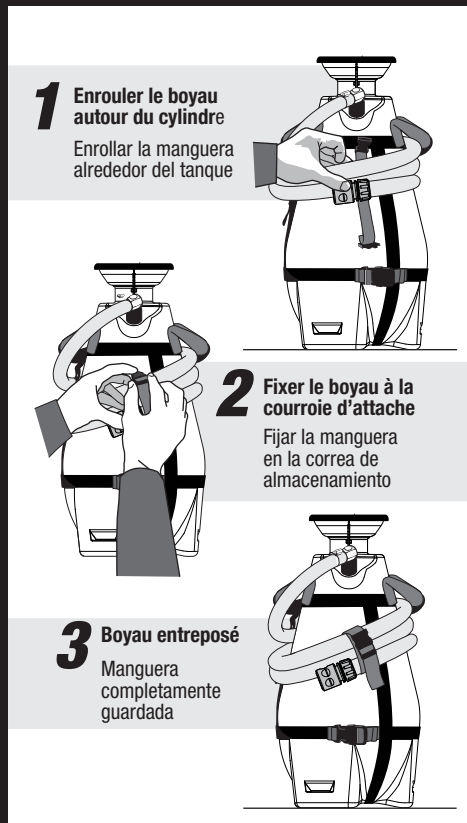

**1** Enrouler le boyau autour du cylindre  
Enrollar la manguera alrededor del tanque

**2** Fixer le boyau à la courroie d'attache  
Fijar la manguera en la correa de almacenamiento

**3** Boyau entreposé  
Manguera completamente guardada

**Nettoyage**  
**Limpieza**

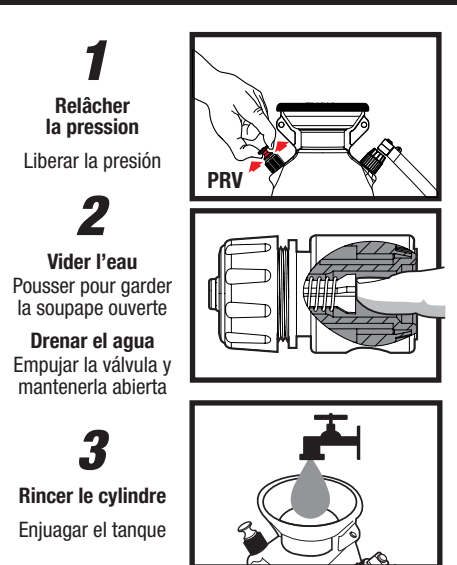

**Liste de pièces de rechange / Lista de refacciones**

Entièrement assemblé / Completamente armado	No. 190655
Connexion rapide / Conexión rápida	No. 183820
Assemblage du boyau / Assemblage du boyau	No. 183821
Trousse pour pompe et chargeur	No. 184163
Kit de bomba y cargador	No. 184163
Sangles / Arnés	No. 183819
PRV / PRV	No. 182945