



MODEL #: 190812

## INSTRUCTION MANUAL



SMITH® SS25 Shoulder Mounted Bag Spreader  
for Grass Seed, Fertilizer, and more!  
(190812)

Do not return this product to the store.  
For help, information, or parts contact:



Craftsmanship. Innovation. Commitment

[www.thefountainheadgroup.com](http://www.thefountainheadgroup.com)

(800) 311-9903 | [info@thefgi.com](mailto:info@thefgi.com)

23 Garden St. New York Mills, NY, 13417



### ⚠ WARNING

Read and fully understand manual  
before using this product.

Failure to follow instructions could  
result in death or serious injury.

# CONTENTS

IMPORTANT SAFETY INSTRUCTIONS .....	2
ASSEMBLING YOUR SMITH® SS25 BAG SPREADER.....	3
SS25 BAG SPREADER - PRO SETUP RATE SETTING INSTRUCTIONS .....	4
SS25 BAG SPREADER - RATE SETTING INSTRUCTIONS .....	5
SETTING EXAMPLES FOR YOUR SMITH® SS25 .....	5
HOW TO USE THE SMITH® SS25 .....	6
SMITH® SS25 SPARE PARTS .....	7
SMITH® SS25 SPARE PARTS MODEL.....	7
WARRANTY STATEMENT.....	8

## IMPORTANT SAFETY INSTRUCTIONS

- Read and understand the entire instruction manual before using this seeder/spreader/spreader.
- Follow all instructions and precautions in the instruction manual when using this seeder/spreader.
- ▲ **WARNING: RISK OF PERSONAL INJURY DUE TO CONTACT WITH ROTATING COMPONENTS.**
- Keep hands and feet away from wheels, belts, and pulleys when seeder/spreader is in motion.
- Never modify or alter the seeder/spreader from original condition.
- Use only replacement parts from original manufacturer. Other replacement parts are not compatible with this seeder/spreader.

**SAVE THESE INSTRUCTIONS FOR FUTURE USE.**

# ASSEMBLING YOUR SMITH® SS25 BAG SPREADER

1. Locate the main unit. Inside the bag, you will find the crank handle.

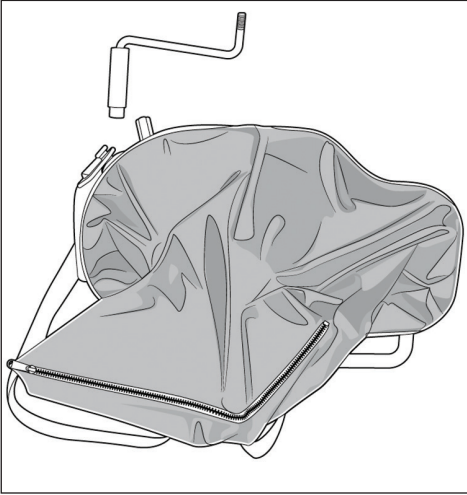

2. To attach the crank handle, screw the crank handle onto the shaft by turning it in a clockwise direction.

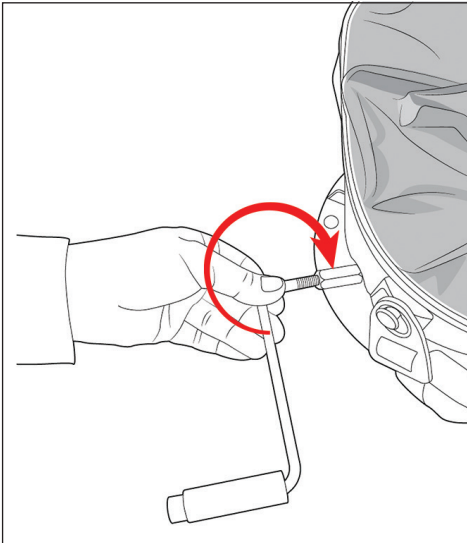

3. To operate, the aperture is set on the gauge assembly as shown by locking the wing nut in the desired position on the 1 to 6 scale.

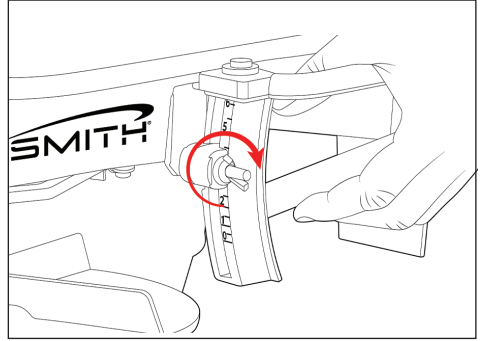

4. Once the desired application rate is set on the gauge, fill the bag with the fertilizer or seed material. Crank the handle at approximately 1 revolution a second. At the point of walking forward, squeeze the lever up into the preset position and material will be evenly spread out in front as the impellor rotates. Once the area to be treated is covered, release the lever into the closed position and stop the cranking of the handle.

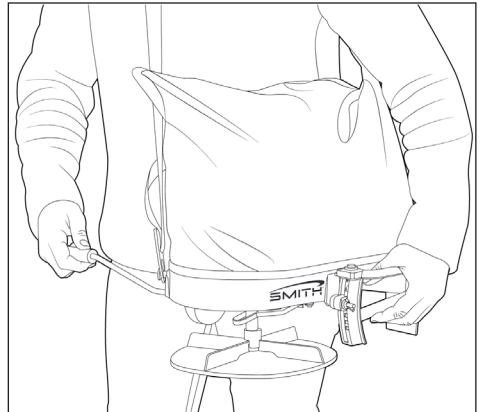

# SS25 BAG SPREADER - PRO SETUP RATE SETTING INSTRUCTIONS

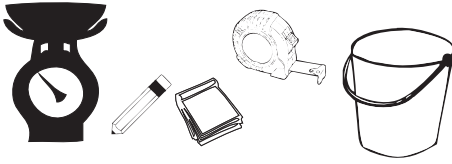

## You Will Need:

- Tape Measure
- Pencil & Pad
- Scale
- Bucket/container

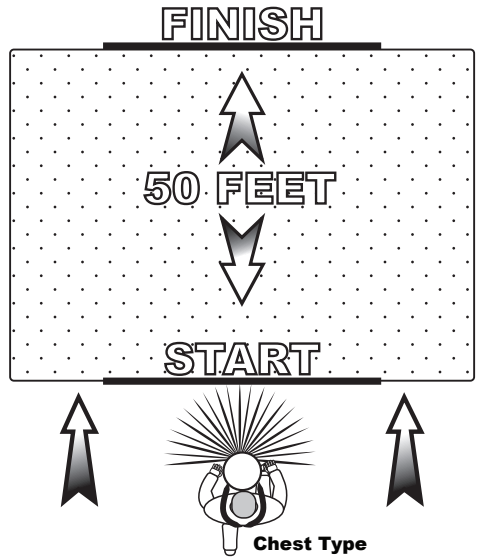

## To Calculate Rate Settings:

Determine how much material is to be applied per 1,000 sq./ft. This is determined on the bag based on bag weight and total area of coverage if not directly stated on the bag the recommended number of pounds per 1,000 sq./ft..

- Measure off a distance of 50 feet, preferably on a paved surface such as a parking lot.
- Weigh enough of the material to be applied to fill the bag at least half full.
- Record the weight for future use.
- With the unit positioned correctly for comfortable use, on your left hip and the bag at least half full of the material to be spread, position yourself far enough before the beginning of the 50 foot test area so that you will achieve the desired speed before you reach the starting line.
- Select the Setting Rate position that you feel would be an appropriate setting on the seeder/spreader/spreader (start in the middle).
- Start walking at a **NORMAL** pace cranking the handle so that it makes **one revolution for each step** with either your right or left foot to ensure the proper distribution rate.
- As you cross the starting line (of the 50 feet) move the rate lever to the open position against the stop.
- Continue from the starting line with the unit spreading the material. As you cross the finish line move the rate control lever to the closed position.
- Stop walking and measure the spread width and note it on the CHART section on the next page.
- Return to the start point and empty the remaining material from the hopper into your weighing container and re-weigh to determine the amount that you used to cover the 50 foot path by the spread width that you determined in the previous step.

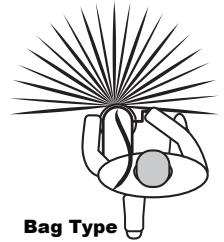

Bag Type

# SS25 BAG SPREADER - RATE SETTING INSTRUCTIONS

## Chart:

Desired Application Rate (lbs./1,000 sq. ft.) \_\_\_\_\_

To determine the desired application rate divide the area (sq. ft.) that the bag says it should cover, by the weight of the bag, and then multiply by 1,000. (Example: 5,000 sq. ft. / 25 lbs. = .005 x 1,000 = 5lbs. per 1,000 sq. ft.)

\_\_\_\_\_ Weight of Material Placed in Bag/Hopper  
 - \_\_\_\_\_ Subtract the Weight of Material Left in Bag  
 = \_\_\_\_\_ Weight of Material Used

\_\_\_\_\_ X 50 Multiply by the Width of Spread Area by Length (50 feet)  
 = \_\_\_\_\_ Total Spread Area

Divide the Weight of Material Used by the Total Spread Area = \_\_\_\_\_ lbs.\sq. ft.

Multiply the lbs.\sq. ft. from above times 1,000 = \_\_\_\_\_ lbs.\1,000 sq. ft.

Compare the results of your test to the desired application rate.

Adjust the rate setting stop accordingly and run through the test again.

Repeat this process until you have achieved the desired application rate.

These settings are intended as a guide only. Variations in physical characteristics of material applied, brisk walking speed (3 mph.), and roughness of ground surface may require slightly different spreader settings. Due to the above conditions, The Fountainhead Group, Inc. makes no warranty as to the uniformity of coverage actually obtained from the setting listed.

## SETTING EXAMPLES FOR YOUR SMITH® SS25

FIELD SEED	SPREAD WIDTH	SETTING RATE	LBS. per ACRE	FIELD SEED	SPREAD WIDTH	SETTING RATE	LBS. per ACRE
Alfalfa	18	2 ½	20	Rape	21	2 ½	6 ¾
Kentucky 31	11	3 ½	5	Sweet Sudan Grass	24	3 ¾	25
Birdsfoot Trefoil	20	1 ¾	4	Timothy	14	1	2 ¾
Clovers	18	2.25	8	Wheat	25	4 ½	90
Flax or Millet	18	2 ½	25	Yellow Mustard	20	2 ½	7 2/3
Hairy Vetch	18	3 ½	20				
Kentucky Blue Grass	8	3 ½	49 ½				
Lespedeza Unhulled	16	2	15	LAWN SEED	SPREAD WIDTH	SETTING RATE	LBS. per 1,000 SQ. FT.
Lespedeza Hulled	16	2	12	Bermuda	7 ½	1	2 ¼
Oats	16	6	64	Merlon Blue	7 ½	2 ½	¼
Orchard Grass	10	2 ½	14	Rye Grass	13	4 ½	1
Red Top	10	1 ½	6	Fine Seed Mixtures	10	3 ½	4
Imperial White Tall Clover	18	1 ¾	8	Coarse Seed Mixtures	12	4 ½	1

# HOW TO USE THE SMITH® SS25

## Walking Patterns for the optimum application

There are two methods of effective spreading, Full Rate (Single Pass over the area at the setting for the full amount) and Half Rate (Double pass over the area in a crossing pattern at 50% of the full amount - details below). Make sure that you walk at a steady pace of 3mph holding the spreader stable, not tipping forward or back as this will affect your application.

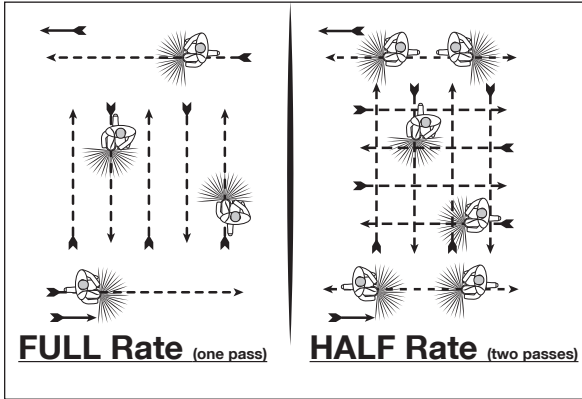

### Full Rate - one pass

Cover the area as shown making the next pass at the edge of your spread pattern or where the fertilizer thrown begins to feather.

### HALF Rate - 2 passes

Use ½ the application rate (lbs. per 1,000) suggested on the back of your fertilizer bag. You cover the area using the cross path method.

Half rate is defined by reducing the pounds per thousand square feet by 50%. This does NOT correlate to a 50% reduction on the gauge indicator. Refer to the chart below for the proper half rate setting.

# SMITH® SS25 SPARE PARTS

Item	Part Number	Description
A	186271	Spreader Base with Bag, CRP5001, SS-25
B	186272	Rate Bezel, Stroke Stopper & Fasteners, CRP5002, SS-25
C	186273	Gearbox, CRP5003, SS-25
D	186274	Hand Crank, CRP5004, SS-25
E	186275	Shut-off Plate, CRP5005, SS-25
F	186276	Control Lever, CRP5006, SS-25
G	186277	Cross Member, CRP5007, SS-25
H	186278	Impellor + Cotter Pin, CRP5008, SS-25
J	186279	Gearbox Cam, CRP5009, SS-25
K	186280	Hardware Pack, CRP5010, SS-25

## SMITH® SS25 SPARE PARTS MODEL

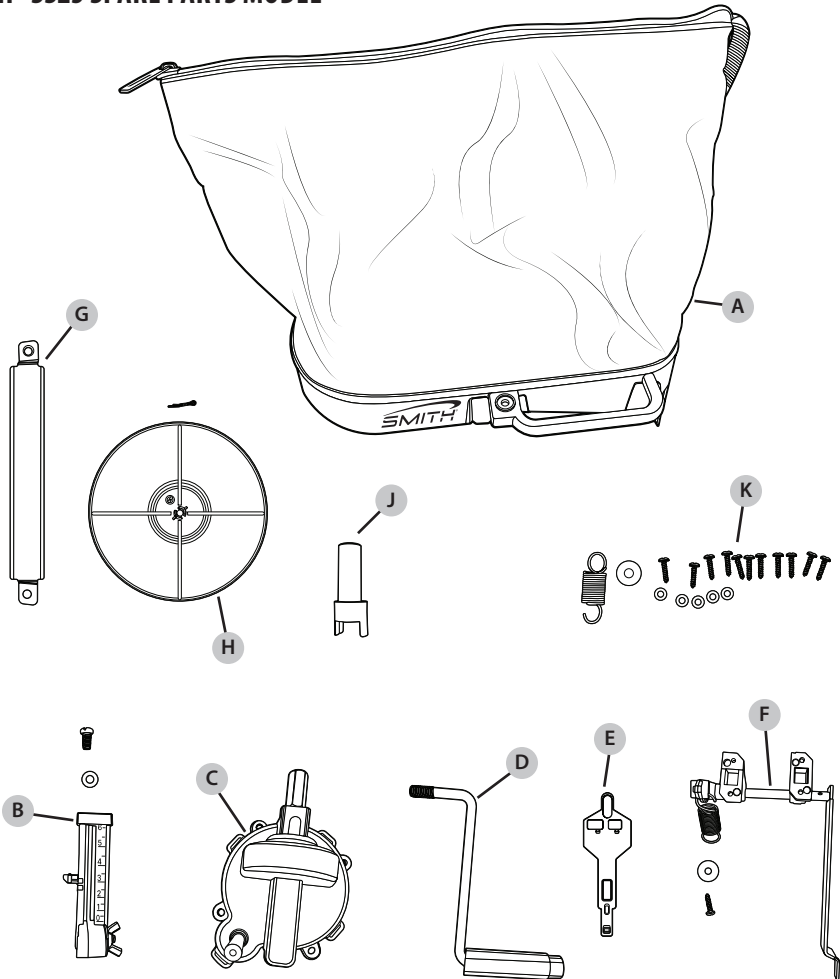

# WARRANTY STATEMENT

## 1-Year Limited Warranty

This limited warranty gives you, the original product purchaser, specific legal rights. You may also have other rights, which vary from state to state.

The Fountainhead Group, Inc. (FGI) warrants to the original product purchaser, that each product will be free from defects in material and workmanship, under normal use and conditions, for a period of one (1) year from the date of purchase. FGI makes no other express warranties, and all implied warranties, including fitness and merchantability, are limited to one (1) year from the date of purchase.

If the product fails to function as intended, call our customer support hotline at +1-800-311-9903 or email [info@thefgi.com](mailto:info@thefgi.com). Within the warranty period, FGI will repair or replace any part found to be defective upon our examination. FGI reserves the right to require the return of the defective product with the proof of purchase to establish a claim under this warranty. The warranty period is not extended if we repair or replace the product. All shipping expenses will be covered by the customer.

This limited warranty does not cover any damage or defect resulting from transportation, storage, maintenance, improper use, negligence, accident, normal wear, alterations, or operation or any other activity or action which is not in accordance with the instruction manual. Any parts that are deemed wearable parts are not part of the limited warranty.

In no event shall FGI be liable for any incidental, special, consequential or punitive damages, or for any attorney fees, expenses, losses or delays alleged to be as a consequence of any damage to, failure of, or inadequate product training, but not limited to, any claims for loss of profits.



